

1.3 mm Height Subminiature , Axial Flat Top LEDs

 MODEL NO : 28-21SYGC/S530-E1/TR8

■ Features :

- Package in 12mm tape on 7" diameter reels.
- Compatible with automatic placement equipment.
- Compatible with infrared and vapor phase reflow solder process.
- I.C. compatible.
- EIA std package.
- Mono-color type.

■ Descriptions :

- The 28-21 SMD taping is much smaller than leaded components. Thusenable smaller board size.Higher packing density. Reduced storage space and finally smaller equipment to be obtained.
- Besides, light weight makes them ideal for miniature application, etc.
- Furthermore by automation assembly machines the accuracy is anticipated.

■ Applications :

- Small indicator for outdoor applications.
- Flat backlight for LCD, switch and symbol.
- Indicator and backlight in office equipment.
- Indicator and backlight for battery driven equipment.
- Indicator and backlight for audio and video equipment.
- Automotive : backlighting in dashboard and switch.
- Telecommunication : indicator and backlighting in telephone and fax.
- General use.

■ Package Dimensions :

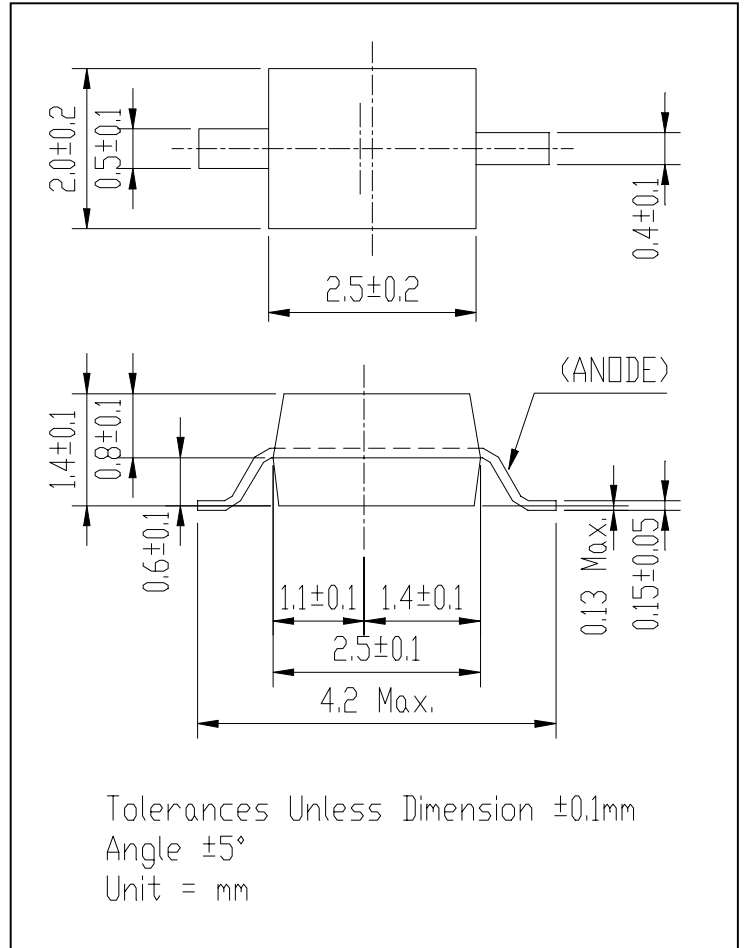

| PART NO. | CHIP | | Lens Color |
|----------------------|----------|--------------------|-------------|
| | Material | Emitted Color | |
| 28-21SYGC/S53-E1/TR8 | AlGaInP | Super Yellow Green | Water Clear |

Office : NO 25,Lane 76, Chung Yang Rd, Sec.3, Tucheng, Taipei 236, Taiwan, R.O.C.

TEL : 886-2-2267-2000,2266-9936(22 Lines)

FAX : 886-2-2267-6189

<http://www.everlight.com>

1.3 mm Height Subminiature , Axial Flat Top LEDs

MODEL NO : 28-21SYGC/S530-E1/TR8

■ Package Dimensions

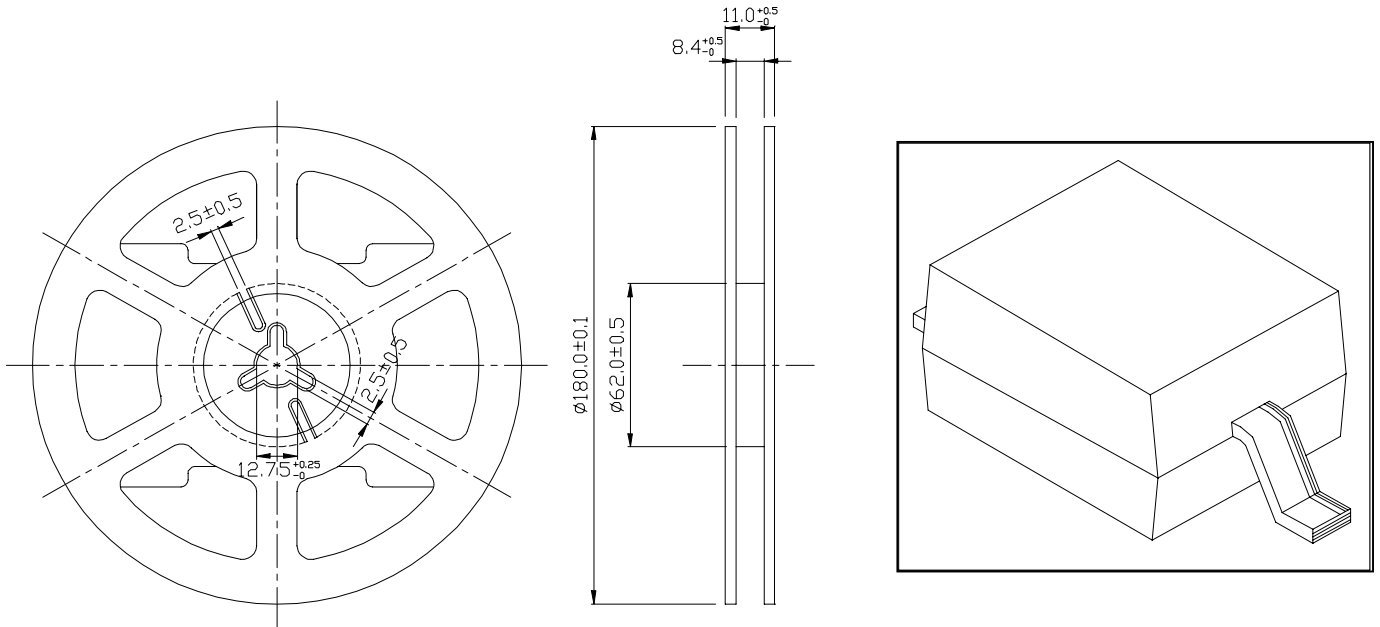

■ Loaded Quantity Per Reel 2000 Pcs/Reel

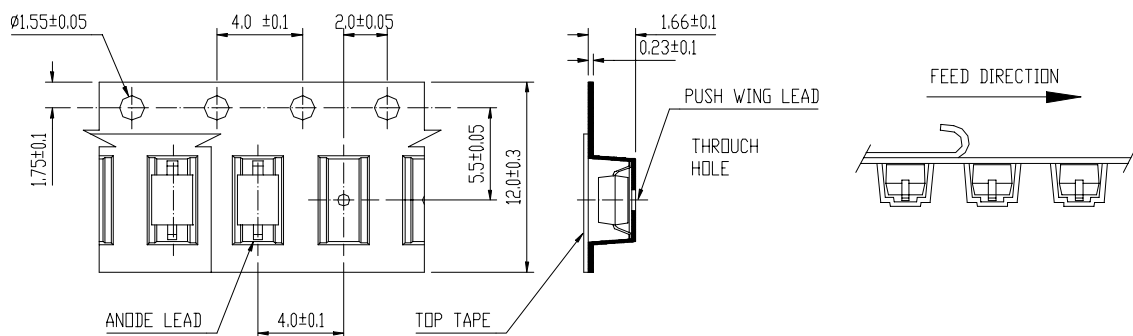

1. All dimensions are in millimeters.
2. Lead spacing is measured where the lead emerge from the package
3. Protruded resin under flange 1.5 mm (0.59") max.



1.3 mm Height Subminiature , Axial Flat Top LEDs

MODEL NO : 28-21SYGC/S530-E1/TR8

■ Absolute Maximum Ratings at Ta = 25°C

| Parameter | Symbol | Rating | Unit |
|--|----------|-------------------|------|
| Reverse Voltage | Vr | 5 | V |
| Forward Current | If | 40 | mA |
| Operating Temperature | Topr | -30 ~ +80 | °C |
| Storage Temperature | Tstg | -40 ~ +100 | °C |
| Soldering Temperature | Tsol | 260 ± 5 for 5 sec | °C |
| Electrostatic Discharge | ESD | 2000 | V |
| Power Dissipation | Pd | 100 | mW |
| Peak Forward Current(Duty 1/10 @ 1KHZ) | If(Peak) | 180 | mA |

■ Electronic Optical Characteristics :

| Parameter | Symbol | MIN. | TYP. | MAX. | Unit | Condition |
|------------------------------|--------|------|------|------|------|-----------|
| Luminous intensity | Iv | ---- | 1 | ---- | mcd | If = 2mA |
| Luminous intensity | Iv | 8 | 12 | ---- | mcd | If = 20mA |
| Viewing Angle | 2θ 1/2 | ---- | 150 | ---- | deg | |
| Peak Wavelength | λ p | ---- | 575 | ---- | nm | |
| Dominant Wavelength | λ d | ---- | 573 | ---- | nm | |
| Spectrum Radiation Bandwidth | Δ λ | ---- | 20 | ---- | nm | |
| Forward Voltage | Vf | ---- | 2.0 | 2.4 | V | |
| Reverse Current | Ir | ---- | ---- | 10 | μ A | Vr=5V |



EVERLIGHT ELECTRONICS CO.,LTD.

DEVICE NUMBER : DLE-282-080 REV : 1.1

ECN : _____ PAGE : 4/5

1.3 mm Height Subminiature , Axial Flat Top LEDs

MODEL NO : 28-21SYGC/S530-E1/TR8

Reliability Test Item And Condition

| NO. | Item | Test Conditions | Test Hours/ Cycle | Sample Size | Ac/Re |
|-----|----------------------------------|--|----------------------|----------------|-------|
| 1 | Solder Heat | TEMP : 260 ± 5 | 5 sec | 76 pcs | 0/1 |
| 2 | Temperature Cycle | H : +85 30 min ↕ 5 min ↕ L : -55 30 min | 50 cycle | 76 pcs | 0/1 |
| 3 | Thermal Shock | H : +100 5 min ↕ 10 sec ↕ L : -10 30 min | 50 cycle | 76 pcs | 0/1 |
| 4 | High Temperature Storage | TEMP. : +100 | 1000 hrs | 76 pcs | 0/1 |
| 5 | Low Temperature Storage | TEMP. : -55 | 1000 hrs | 76 pcs | 0/1 |
| 6 | DC Operating Life | If = 20 mA | 1000 hrs | 76 pcs | 0/1 |
| 7 | High Temperature / High Humidity | 85 / 85% R.H. | 1000 hrs | 76 pcs | 0/1 |



1.3 mm Height Subminiature , Axial Flat Top LEDs

MODEL NO : 28-21SYGC/S530-E1/TR8

Typical Electro-Optical Characteristic Curres

